

## READING

### READING PASSAGE 1

You should spend about 20 minutes on Questions 1-13, which are based on Reading Passage 1 below.

#### The nature of Yawning

A. While fatigue, drowsiness or boredom easily bring on yawns, scientists are discovering there is more to yawning than most people think. Not much is known about why we yawn or if it serves any useful function. People have already learned that yawning can be infectious. “Contagious yawning” is the increase in likelihood that you will yawn after watching or hearing someone else yawn, but not much is known about the under-lying causes, and very little research has been done on the subject. However, scientists at the University of Albany, as well as the University of Leeds and the University of London have done some exploration.

B. It is commonly believed that people yawn as a result of being sleepy or tired because they need oxygen. However, the latest research shows that a yawn can help cool the brain and help it work more effectively, which is quite different from the popular belief that yawning promotes sleep and is a sign of tiredness. Dr. Andrew Gallup and his colleagues at the University of Albany in New York State said their experiments on 44 students showed that raising or lowering oxygen and carbon dioxide levels in the blood did not produce that reaction. In the study participants were shown videos of people laughing and yawning, and researchers counted how many times the volunteers responded to the “contagious yawns”. The researchers found that those who breathed through the nose rather than the mouth were less likely to yawn when watching a video of other people yawning. The same effect was found among those who held a cool pack to their forehead, whereas those who held a warm pack yawned while watching the video. Since yawning occurs when brain temperature rises, sending cool blood to the brain serves to maintain the best levels of mental efficiency.

C. Yawning is universal to humans and many animals. Cats, dogs and fish yawn just like humans do, but they yawn spontaneously. Only humans and chimpanzees, our closest relatives in the animal kingdom, have shown definite contagious yawning. Though much of yawning is due to suggestibility, sometimes people do not need to actually see a person yawn to involuntarily yawn themselves: hearing someone yawning or even reading about yawning can cause the same reaction.

D. However, contagious yawning goes beyond mere suggestibility. Recent studies show that contagious yawning is also related to our predisposition toward empathy—the ability to understand and connect with others’ emotional states. So empathy is important, sure, but how could it possibly be related to contagious yawning? Leave it up to psychologists at Leeds University in England to answer that. In their study, researchers selected 40 psychology students and 40 engineering

students. Generally, psychology students are more likely to feel empathy for others, while engineering students are thought to be concerned with objects and science. Each student was made to wait individually in a waiting room, along with an undercover assistant who yawned 10 times in as many minutes. The students were then administered an emotional quotient test: students were shown 40 images of eyes and asked what emotion each one displayed. The results of the test support the idea that contagious yawning is linked to empathy. The psychology students—whose future profession requires them to focus on others—yawned contagiously an average of 5.5 times in the waiting room and scored 28 out of 40 on the emotional test. The engineering students—who tend to focus on things like numbers and systems—yawned an average of 1.5 times and scored 25.5 out of 40 on the subsequent test. The difference doesn't sound like much, but researchers consider it significant. Strangely enough, women, who are generally considered more emotionally attuned, didn't score any higher than men.

E. Another study, led by Atsushi Senju, a cognitive researcher at the University of London, also sought to answer that question. People with autism disorder are considered to be developmentally impaired emotionally. Autistics have trouble connecting with others and find it difficult to feel empathy. Since autistics have difficulty feeling empathy, then they shouldn't be susceptible to contagious yawning. To find out, Senju and his colleagues placed 49 kids aged 7 to 15 in a room with a television. 24 of the test subjects had been diagnosed with autism spectrum disorder, the other 25 were non-autistic kids. The test subjects were shown short clips of people yawning as well as clips of people opening their mouths but not yawning. While the kids with autism had the same lack of reaction to both kinds of clips, the non-autistic kids yawned more after the clips of people yawning. F. There also have been studies that suggest yawning, especially psychological "contagious" yawning, may have developed as a way of keeping a group of animals alert and bonding members of a group into a more unit one. If an animal is drowsy or bored, it may not be as alert as it should be prepared to spring into action and its yawning is practically saying, "Hey, I need some rest, you stay awake". Therefore, a contagious yawn could be an instinctual reaction to a signal from one member of the herd reminding the others to stay alert when danger comes. So the theory suggests evidence that yawning comes from the evolution of early humans to be ready to physically exert themselves at any given moment.

Question 1 - 5

Read paragraphs A—F. Which paragraph contains the following information? NB You may use any letter more than once.

- 1 Humans' imaginations can cause yawning.
- 2 Research shows that yawning is closely related to occupations.
- 3 An overview of the latest research in yawning.
- 4 Yawning is used to regulate brain temperature.
- 5 Scientists discovered some evidence disproving the early understanding of yawning.

Questions 6 - 9

Match each of the following research results with the university which it comes from  
NB You may use any letter more than once.

- A. University of Albany
- B. University of Leeds
- C. University of London

- 6 There is no gender difference in the cause of yawning.
- 7 People with certain disorders are less likely to be affected by other people yawning.
- 8 Yawning is associated with the way people breathe.
- 9 People who are trained to feel empathy for others are more likely to yawn than those who are untrained.

Questions 10 - 13

Complete the summary below. Choose ONE WORD from the passage for each answer.

Write your answers in boxes 10-13 on your answer sheet.

Another theory shows that yawning is used for 10..... individuals into a tighter social unit. Alternatively, yawning can help increase alertness of group members in case 11 ..... is close. For example, yawning signals that a member of the group needs some 12 ..... and requires the others to stay aware of the surrounding situation. This theory proves that yawning is only a spontaneous behavior resulting from some part of a simple 13..... system in early humans.

READING PASSAGE 2

You should spend about 20 minutes on Questions 14-26, which are based on Reading Passage 2 below.

### **Water Treatment 2 : Reed Bed**

In recent years, it has been shown that plants, more accurately roots, play a crucial part in purifying dirty water before it enters seas and rivers. In 15th-century Britain, dirty water was purified by passing through the wetlands. People began to realize that the “natural” way of water purification was effective. Nowadays subsurface flow wetlands (SSFW) are a common alternative in Europe for the treatment of wastewater in rural areas, Mainly in the last 10 to 12 years there has been a significant growth in the number and size of the systems in use. The conventional mechanism of water purification used in big cities where there are large volumes of water to be purified is inappropriate in rural areas.

The common reed has the ability to transfer oxygen from its leaves, down through its stem and rhizomes, and out via its root system. As a result of this action, a very high population of microorganisms occurs in the root system, in zones of aerobic, anoxic, and anaerobic conditions. As the waste water moves very slowly through the mass of reed roots, this liquid can be successfully treated. The reason why they are so effective is often because within the bed’s root sector, natural biological, physical and chemical processes interact with one another to degrade or remove a good range of pollutants.

Dirty water from households, farms and factories consume a lot of oxygen in the water, which will lead to the death of aquatic creatures. Several aquatic plants are important in purifying water. They not only absorb carbon dioxide and release oxygen into the water, improving the environment for fish, but absorb nutrients from the water as well. Britain and the U.S. differ in their preference of plants to purify water. Bulrushes (*Scirpus* spp.) and rushes (*Juncus* spp.) are excellent water purifiers. They remove excess nutrients from the water as well as oil and bacteria such as *Escherichia coli* and *Salmonella*. However, algae grow freely in summer and die off in winter. Their remains foul the bottom of the pool.

Artificial reed beds purify water in both horizontal and downflow ways. The reeds succeed best when a dense layer of root hairs has formed. It takes three years for the roots to fully develop. Which type of wetland a certain country applies varies widely depending on the country in Europe and its main lines of development. Besides the development of horizontal or vertical flow wetlands for wastewater treatment, the use of wetlands for sludge treatment has been very successful in Europe. Some special design lines offer the retention of microbiological organisms in constructed wetlands, the treatment of agricultural wastewater, treatment of some kinds of industrial waste-water, and the control of diffuse pollution.

If the water is slightly polluted, a horizontal system is used. Horizontal-flow wetlands may be of two types: free-water surface-flow (FWF) or sub-surface water-flow (SSF). In the former the effluent flows freely above the sand/gravel bed in which the reeds etc. are planted; in the latter effluent passes through the sand/gravel bed. In FWF-type wetlands, effluent is treated by plant stems, leaves and rhizomes. Such FWF wetlands are densely planted and typically have water-depths of less than 0.4m. However, dense planting can limit the diffusion of oxygen into the water. These systems work particularly well for low strength effluents or effluents that have undergone some forms of pretreatment and play an invaluable role in tertiary treatment and the polishing of effluents. The horizontal reed flow system uses a long reed bed, where the liquid slowly flows horizontally through. The length of the reed bed is about 100 meters. The downside of horizontal reed beds is that they use up lots of land space and they do take quite a long time to produce clean water.

A vertical flow (downflow) reed bed is a sealed, gravel filled trench with reeds growing in it. The reeds in a downflow system are planted in a bed 60cm deep. In vertical flow reed beds, the wastewater is applied to the top of the reed bed, flows down through a rhizome zone with sludge as a substrate, then through a root zone with sand as a substrate, followed by a layer of gravel for drainage, and is collected in an under drainage system of large stones. The effluent flows onto the surface of the bed and percolates slowly through the different layers into an outlet pipe, which leads to a horizontal flow bed where it is cleaned by millions of bacteria, algae, fungi, and microorganisms that digest the waste, including sewage. There is no standing water so there should be no unpleasant smells.

Vertical flow reed bed systems are much more effective than horizontal flow reed-beds not only in reducing biochemical oxygen demanded (BOD) and suspended solids (SS) levels but also in reducing ammonia levels and eliminating smells. Usually considerably smaller than horizontal flow beds, they are capable of handling much stronger effluents which contain heavily polluted matters and have a longer lifetime value. A vertical reed bed system works more efficiently than a horizontal reed bed system, but it requires more management, and its

reed beds are often operated for a few days then rested, so several beds and a distribution system are needed.

The natural way of water purification has many advantages over the conventional mechanism. The natural way requires less expenditure for installation, operation and maintenance. Besides, it looks attractive and can improve the surrounding landscape. Reed beds are natural habitats found in floodplains, waterlogged depressions and estuaries. The natural bed systems are a biologically proved, an environmentally friendly and visually unobtrusive way of treating wastewater, and have the extra virtue of frequently being better than mechanical wastewater treatment systems. Over the medium to long term reed bed systems are, in most cases, more cost effective to install than any other wastewater treatment. They are naturally environmentally sound protecting groundwater, dams, creeks, rivers and estuaries.

Questions 14 - 16

Do the following statements agree with the information given in Reading Passage 2?  
In boxes 14-16 on your answer sheet, write

TRUE if the statement agrees with the information

FALSE if the statement contradicts the information

NOT GIVEN if there is no information on this

14 The reed bed system is a conventional method for water treatment in urban areas.

15 In the reed roots, there is a series of processes that help break down the pollutants.

16 Escherichia coli is the most difficult bacteria to eliminate.

Questions 17-19

Complete the diagram below. Choose NO MORE THAN THREE WORDS from the passage for each answer.

### **Downflow Reed Bed System**

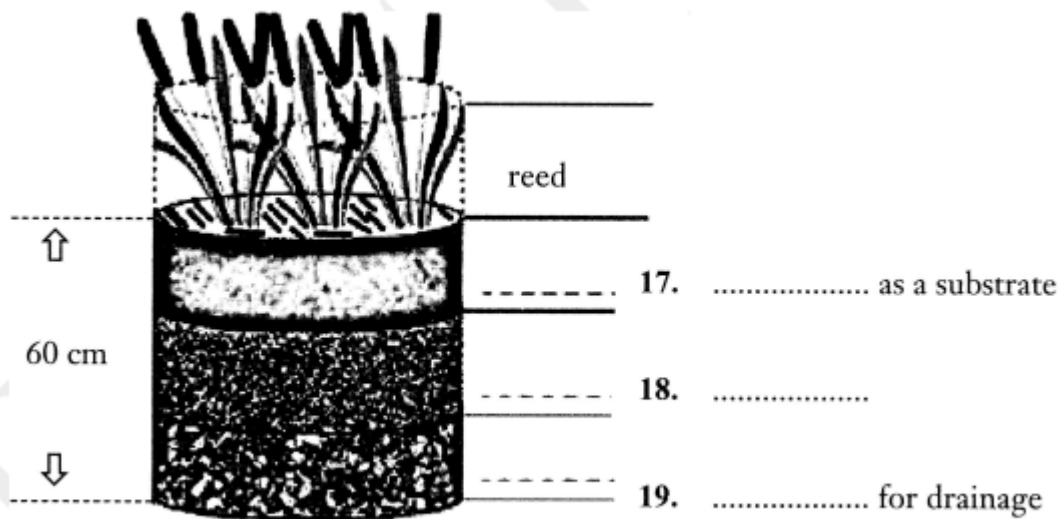

Question 20 - 24

Use the information in the passage to match the advantages and disadvantages of the two systems: horizontal flow system and down-flow system (listed A—H) below. Write the appropriate letters A-H in boxes 20-24 on your answer sheet.

The advantage of the downflow system is 20.....; however, 21 ..... and 22.....The two advantages of the horizontal system are 23.....and 24.....In comparison with the downflow system, the horizontal system is less effective.

- A. it requires several beds
- B. it is easier to construct
- C. it builds on a gradient
- D. it doesn't need much attention
  
- E. it produces less sludges
- F. it isn't always working
- G. it needs deeper bed
- H. it can deal with more heavily polluted water

Questions 25-26

Choose two correct letters, from the following A, B, C, D or E. Write your answers in boxes 25—26 on your answer sheet. What are the TWO advantages of the natural water purification system mentioned in the passage:

- A. It uses micro-organisms
- B. It involves a low operating cost
- C. It prevents flooding. D. It is visually good-looking
- E. It can function in all climates

## READING PASSAGE 3

### History of telegraph in communication

Jean-Antoine Nollet was a French clergyman and physicist. In 1746 he gathered about two hundred monks into a circle about a mile (1.6 km) in circumference, with pieces iron wire connecting them. He then discharged a battery of Leyden jars through the human chain and observed that each man reacted at substantially the same time to the electric shock, showing that the speed of electricity's propagation was very high. Given a more humane detection system, this could be a way of signaling over long distances. In 1748, Nollet invented one of the first electrometers, the electroscope, which detected the presence of an electric charge by using electrostatic attraction and repulsion.

After the introduction of the European semaphore lines in 1792, the world's desire to further its ability to communicate from a distance only grew. People wanted a way to send and receive news from remote locations so that they could better understand what was happening in the world around them—not just what was going on in their immediate town or city. This type of communication not only appealed to the media industry, but also to private individuals and companies who wished to stay in touch with contacts. In 1840 Charles Wheatstone from Britain, with William Cooke, obtained a new patent for a telegraphic arrangement. The new apparatus required only a single pair of wires, but the telegraph was still too costly for general purposes. In 1845, however, Cooke and Wheatstone succeeded in producing the single needle apparatus, which they patented, and from that time the electric telegraph became a practical instrument, soon adopted on all the railway lines of the country.

It was the European optical telegraph, or semaphore, that was the predecessor of the electrical recording telegraph that changed the history of communication forever. Building on the success of the optical telegraph, Samuel F. B. Morse completed a working version of the electrical recording telegraph, which only required a single wire to send code of dots and dashes. At first, it was imagined that only a few highly skilled encoders would be able to use it but it soon became clear that many people could become proficient in Morse code. A system of lines strung on telegraph poles began to spread in Europe and America.

In the 1840s and 1850s several individuals proposed or advocated construction of a telegraph cable across the Atlantic Ocean, including Edward Thornton and Alonzo Jackman. At that time there was no material available for cable insulation and the first breakthrough came with the discovery of a rubber-like latex called gutta percha. Introduced to Britain in 1843, gutta percha is the gum of a tree native to the Malay Peninsula and Malaysia. After the failure of their first cable in 1850, the British brothers John and Jacob Brett laid a successful submarine cable from Dover to Calais in 1851. This used two layers of gutta percha insulation and an armoured outer layer. With thin wire and thick insulation, it floated and had to be weighed down with lead pipe.

In the case of first submarine-cable telegraphy, there was the limitation of knowledge of how its electrical properties were affected by water. The voltage which may be impressed on the

cable was limited to a definite value. Moreover, for certain reasons, the cable had an impedance associated with it at the sending end which could make the voltage on the cable differ from the voltage applied to the sending-end apparatus. In fact, the cable was too big for a single boat, so two had to start in the middle of the Atlantic, join their cables and sail in opposite directions. Amazingly, the first official telegram to pass between two continents was a letter of congratulation from Queen Victoria of the United Kingdom to the President of the United States, James Buchanan, on August 16, 1858. However, signal quality declined rapidly, slowing transmission to an almost unusable speed and the cable was destroyed the following month.

To complete the link between England and Australia, John Pender formed the British-Australian Telegraph Company. The first stage was to lay a 557nm cable from Singapore to Batavia on the island of Java in 1870. It seemed likely that it would come ashore at the northern port of Darwin from where it might connect around the coast to Queensland and New South Wales. It was an undertaking more ambitious than spanning ocean. Flocks of sheep had to be driven with the 400 workers to provide food. They needed horses and bullock carts and, for the parched interior, camels. In the north, tropical rains left the teams flooded. In the centre, it seemed that they would die of thirst. One critical section in the red heart of Australia involved finding a route through the McDonnell mountain range and then finding water on the other side. The water was not only essential for the construction teams. There had to be telegraph repeater stations every few hundred miles to boost the signal and the staff obviously had to have a supply of water.

On August 22, 1872, the Northern and Southern sections of the Overland Telegraph Line were connected, uniting the Australian continent and within a few months, Australia was at last in direct contact with England via the submarine cable, too. This allowed the Australian Government to receive news from around the world almost instantaneously for the first time. It could cost several pounds to send a message and it might take several hours for it to reach its destination on the other side of the globe, but the world would never be the same again. The telegraph was the first form of communication over a great distance and was a landmark in human history.

#### Question 27 - 32

Do the following statements agree with the information given in Reading Passage In boxes 27-32 on your answer sheet, write

TRUE if the statement agrees with the information

FALSE if the statement contradicts the information

NOT GIVEN if there is no information on this

27 In the research of the French scientist, metal lines were used to send messages.

28 People increasingly hoped to explore ways of long-distance communication in the late eighteenth century.

29 Using Morse Code to send message needed special personnel to first simplify the message,

30 Morse was a famous inventor before he invented the code.

31 Water was significant to early telegraph repeater stations on the continent.

32 The Australian Government offered funds for the first overland line across the



continent.

Questions 33 - 40

Answer the questions below. Choose NO MORE THAN TWO WORDS from the passage for each answer. Write your answers in boxes 33-40 on your answer sheet.

33 Why did Charles Wheatstone's telegraph system fail to come into common use in the beginning?

34 What material was used for insulating cable across the sea?

35 What was used by British pioneers to increase the weight of the cable in the sea?

36 What would occur in the submarine cable when the voltage was applied?

37 Who was a message first sent to across the Atlantic by the Queen?

38 What animals were used to carry the cable through desert?

39 What weather condition delayed construction in north Australia?

40 How long did it take to send a telegraph message from Australia to England in 1872?

## **LISTENING**

TEST 1

### SECTION 1

Question 1-5

Complete the table below. Write ONE WORD AND/OR NUMBERS for each answer.

Question 6 -10

Complete the notes below. Write ONE WORD ONLY for each answer.

<b>JOB HUNTING</b>			
Company's name	Job details	Reference number	Contact
<i>Example</i> <b>POWER</b> (manufacturing company)	<ul style="list-style-type: none"> <li>• work in a <b>1</b> .....</li> <li>section</li> </ul>	SW35FT	Jane <b>2</b> .....
<b>COTTON</b> (grocery company)	<ul style="list-style-type: none"> <li>• good pay</li> <li>• work               <ul style="list-style-type: none"> <li>– in <b>3</b> ..... office</li> <li>– in a <b>4</b> .....</li> </ul> </li> <li>• chance of promotion</li> </ul>	<b>5</b> .....	go to office

#### Notes on Jobs

- Local jobs can be found in the 6 .....
- Buy the 7..... to get one free magazine (Job Plus)
- Feel stress and spend a lot of time looking for jobs
- Advisable to go to an 8 ..... instead of the recruitment seminar
- Bring a student card (10% discount)
- Referee:
  - former boss (once had a job)
  - one of the 9 ..... (if not)
- Intend to take the art course
- Fill out a 10 ..... form at the end of the course

#### SECTION 2

Question 11 - 15

Choose the correct letter, A, B or C.

11 The reason why David is replacing Jane is that

- A. she is unwell.
- B. she is very busy.
- C. she is inexperienced.

12 According to the speaker, what is the problem for the museum currently?

- A. lack of staff
- B. lack of publicity
- C. lack of money

13 Why were the thieves able to successfully steal the statue?

- A. The security device is outdated.
- B. The security guard is not well-trained.
- C. They knew what they were searching for.

14 In order to improve security, they are going to

- A. get more closed-circuit television cameras.
- B. hire more security guards.
- C. buy more computers.

15 What kind of librarian are they looking for?

- A. responsible
- B. experienced
- C. highly-trained

Question 16 - 20

Label the map below. Write the correct letter, A-H, next to questions 16-20.

**City Museum**

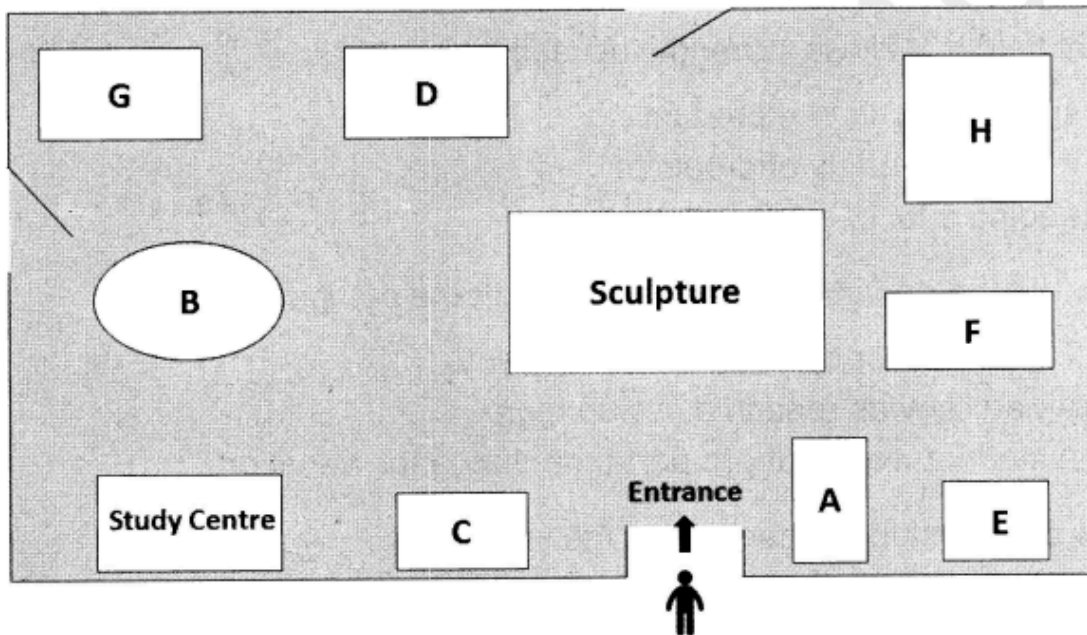

- 16 Box Office .....
- 17 Children's Room .....
- 18 Cafe .....
- 19 Multimedia Room .....
- 20 Showroom .....

**SECTION 3**

Question 21 - 26

Choose the correct letter, A, B or C.

21 What field is Willows currently focused on?

- A. Specialising in one product
- B. making a variety of products
- C. adding a lot of retail outlet

22. How did the students feel about the software?

- A. The professor contacted the company.
- B. An article was read in a newspaper
- C. A student work their part-time during the vacations.

23. How did the student fell about the software

- A. It's not easy to predict.
- B. It's slow for drawing designs
- C. It had a good interface.

24 How did the students find out about the effects of the software on the company?

- A. They went to the IT department.
- B. They talked with the manager.
- C. They inspected the accounts.

25 The reason why the students have a face-to-face interview alone is that

- A. they could prepare for exams.
- B. there will be less disturbance.
- C. it's less realistic.

26 How did the two students perform in the exam?

- A. very disappointing
- B. significantly good
- C. above the average

Question 27 - 28

Choose TWO letters, A-E.

In which TWO ways will the new system affect the company?

- A. gain more profit
- B. employ more new staff
- C. increase sales
- D. reduce production time
- E. cut labour costs

Questions 29 and 30

Choose TWO letters, A

Which TWO effects will the new system have on new clients?

- A. getting more involved in the design
- B. obtaining more contacts
- C. linking at home to do online work
- D. wasting less time
- E. decreasing labour costs

## SECTION 4

Complete the notes below. Write ONE WORD ONLY for each answer.

### A Survey Research

#### Results of Questionnaire

- The patients preferred to choose the hospital because of the free 31..... service provided.
- Most patients wished the hospital to be 32.....
- Patients were concerned about prior 33..... about the hospital treatment.

#### Actions in the next year

- improvements on website for local 34..... as well as hospital medical staff
- incentive to motivate the members of staff
- extra 35..... for staff's success in work
- considering the opinions of the 36 .....
- improving the effectiveness of 37..... between patients, doctors and staff
- first-come-first-served system

#### Recommendation

- A new unit would be built for those who are suffering from 38..... disturbance.
- A new ward would be proposed to those in need of 39..... surgery.
- The equipment is advanced enough to do with the treatments.
- More effective 40..... is needed to improve the efficiency of communication.

## SPEAKING

### PART 1:

- accomodation
- Neighborhood
- Weekend

### PART 2: Ambition

- what is your long ambition
- why you had that ambition
- explain why you choose that ambition

### PART 3: Ambition

- What is the most common ambition of young people?

- Why should young people have ambition?

- ambition people always consider to be selfish in team work-> good or bad? ( should teamwork include ambition? Why?)

## WRITING

- Task 1: The chart below shows the number of international applicants to the universities of one European country. Summarize the information by selecting and reporting the main features, and make comparisons where relevant.

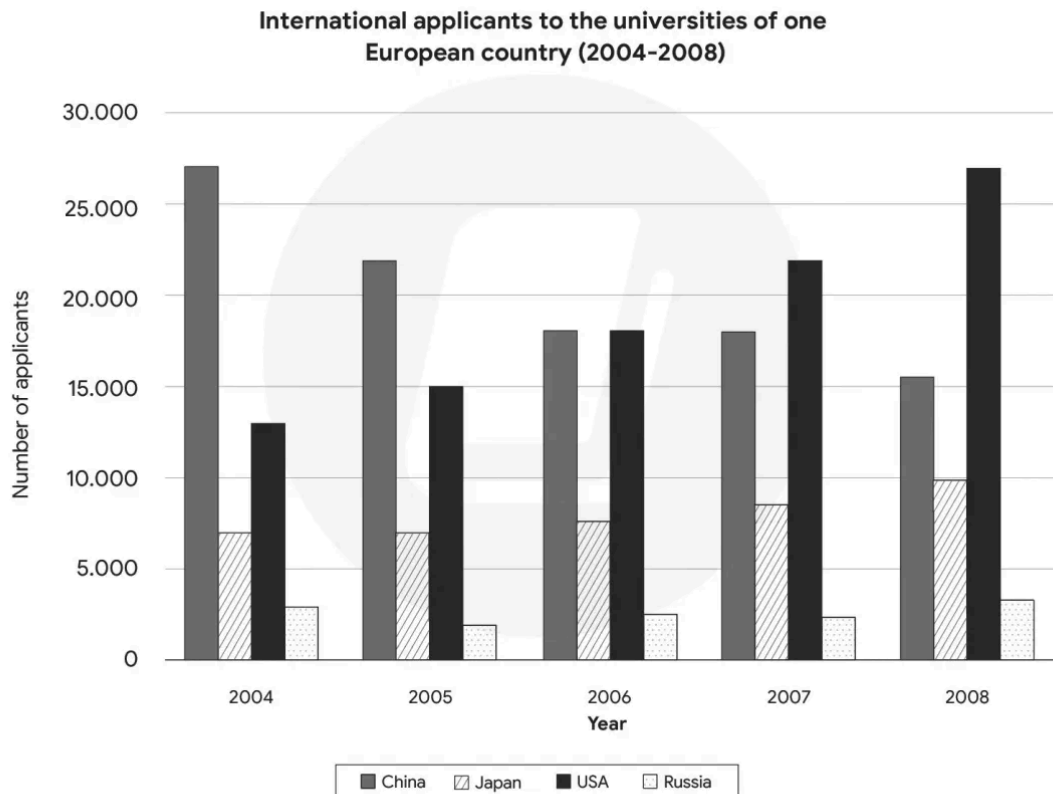

- Task 2: It is predicted that with the development of technology, people in the 21st century will have much more free time. To what extent has the prediction come true? Give reasons for your answer and include any relevant examples from your own knowledge or experience.